

Overview

4 bearing shaft support 1" vertical - Gable drive - PU = 20 pcs

Product number: 25100112

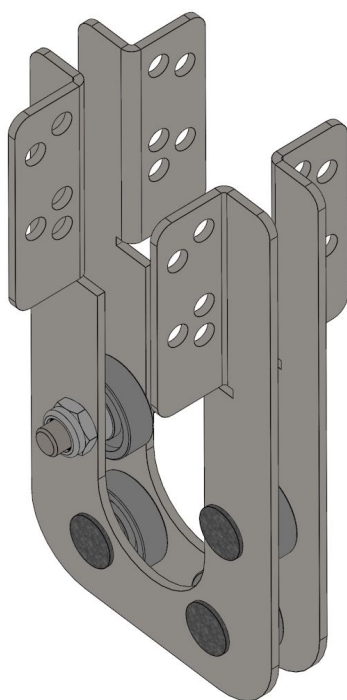

Options

PU (Pcs)

1

20

Description

Our vertical bearing shaft supports 1" allows to set the drive shaft as close as possible to the gable end. In such a construction the shading screens do not set against the truss, but lay either over (in suspended system) or below (in lay-flat system) the square tube, covering the whole area up to the gable end. The delay of screens is basically not needed.

The drive shaft can easily and quickly be pre-assembled on the ground. So dangerous, time-consuming works underneath the roof can be avoided.

The bearings are attached onto the square tubes and locked with locking screws. If needed, they can be moved